

Copyright: All rights reserved.
 This drawing must not be reproduced without permission.
 The topographical survey information reproduced on this drawing is as supplied by 3rd parties (Fieldway Surveys, drawing no. A/ME/100, dated 28.07.16). EWI takes no liability for the accuracy of the information shown.

- KEY**
- Site planning application boundary
- SOFT LANDSCAPE**
- Existing tree to be retained and protected during construction
 - Semi Mature boulevard tree planting to Blair Avenue - 75% consists 'Downspiral' with root barriers as required adjacent to services.
 - Native trees
- HARD LANDSCAPE**
- Mixed native hedge
 - Beech hedge (1m high)
 - Shrub planting
 - bulb planting in grass
 - Grass
- HARD LANDSCAPE**
- Feature paving to pedestrian plaza
 - Feature paving to raised pedestrian crossing
 - General paving
 - Pedestrian grade asphalt concrete
 - Vehicular grade asphalt concrete
 - Feature kerb to pedestrian plaza
 - Standard kerb
- FURNITURE & BOUNDARIES - covered**
- Sheffield Cycle stands - covered
 - Cycle locker
 - Timber seating / bench
 - Bin
 - Steel bollards
 - Lighting column
 - In-ground uplighter
 - Existing school boundary fencing raised on tree alignment
 - 1.8 m high steel bar railing with finish
 - 1.1m high Visiral
 - 1.1m high timber post and wire temporary fencing

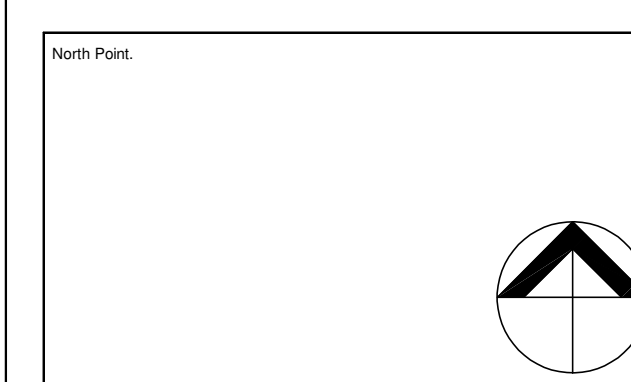
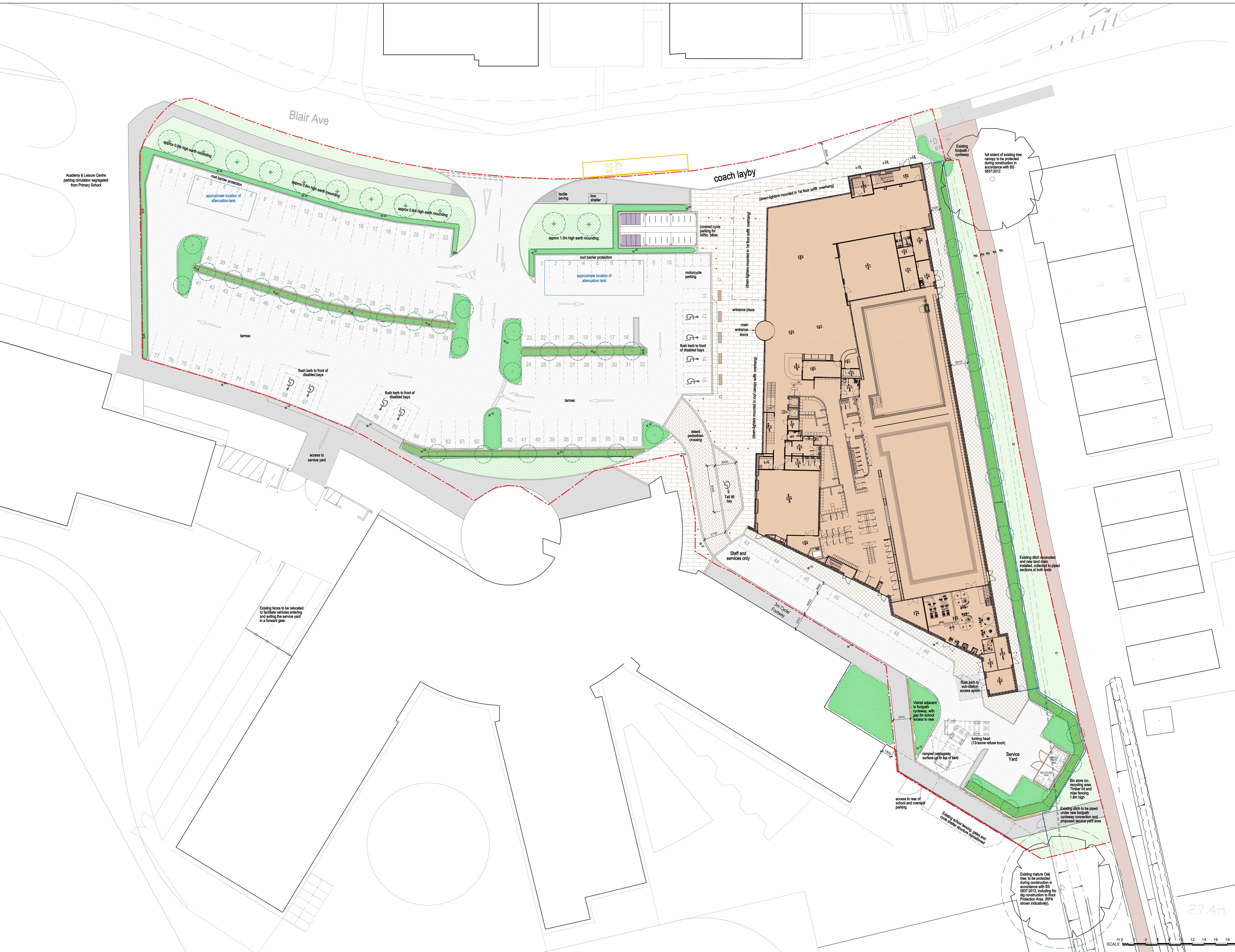

Rev. No. | Description | Date

1	Issue for planning	12.15.16
2	Issue for planning	12.15.16
3	Issue for planning	12.15.16
4	Issue for planning	12.15.16
5	Issue for planning	12.15.16
6	Issue for planning	12.15.16
7	Issue for planning	12.15.16
8	Issue for planning	12.15.16
9	Issue for planning	12.15.16
10	Issue for planning	12.15.16
11	Issue for planning	12.15.16
12	Issue for planning	12.15.16
13	Issue for planning	12.15.16
14	Issue for planning	12.15.16
15	Issue for planning	12.15.16
16	Issue for planning	12.15.16
17	Issue for planning	12.15.16
18	Issue for planning	12.15.16
19	Issue for planning	12.15.16
20	Issue for planning	12.15.16
21	Issue for planning	12.15.16
22	Issue for planning	12.15.16
23	Issue for planning	12.15.16
24	Issue for planning	12.15.16
25	Issue for planning	12.15.16
26	Issue for planning	12.15.16
27	Issue for planning	12.15.16
28	Issue for planning	12.15.16
29	Issue for planning	12.15.16
30	Issue for planning	12.15.16
31	Issue for planning	12.15.16
32	Issue for planning	12.15.16
33	Issue for planning	12.15.16
34	Issue for planning	12.15.16
35	Issue for planning	12.15.16
36	Issue for planning	12.15.16
37	Issue for planning	12.15.16
38	Issue for planning	12.15.16
39	Issue for planning	12.15.16
40	Issue for planning	12.15.16
41	Issue for planning	12.15.16
42	Issue for planning	12.15.16
43	Issue for planning	12.15.16
44	Issue for planning	12.15.16
45	Issue for planning	12.15.16
46	Issue for planning	12.15.16
47	Issue for planning	12.15.16
48	Issue for planning	12.15.16
49	Issue for planning	12.15.16
50	Issue for planning	12.15.16
51	Issue for planning	12.15.16
52	Issue for planning	12.15.16
53	Issue for planning	12.15.16
54	Issue for planning	12.15.16
55	Issue for planning	12.15.16
56	Issue for planning	12.15.16
57	Issue for planning	12.15.16
58	Issue for planning	12.15.16
59	Issue for planning	12.15.16
60	Issue for planning	12.15.16

EWI
 Ellis Williams
 Architects

Wellfield, Chester Road
 Preston Brook W.A.T. 88A
 T: +44 1928 752 200
 F: +44 1928 756 903

Ingleby Barwick Multi-Activity Leisure Facility
 Landscape Masterplan

PLANNING

2193 AG(90) 01 G